



Notice:

Razor Reach is designed so that your razor handle will be **held firmly when downward pressure is applied**, as in shaving. You may **notice movement** when downward pressure is not applied.

As with any razor, the razor reach is not intended for side to side (horizontal) shaving motions. The razor reach should be used with the same precautions you utilize with your present razor.

Buyer assumes all risk for safety and use not in accordance with directions.

* 2 Arms available with Razor Reach XR model.

Additional 6" Razor Reach Arms also sold separately. Visit www.razorreach.com to purchase.

®REGISTERED TRADEMARK OF RAZOR REACH INC
2937 NORTH CLARK STREET
CHICAGO, IL 60657
www.razorreach.com

PATENT PENDING

Razor Reach has 4 different parts.

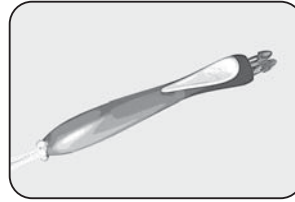

Handle



Extension Arm



Universal Head

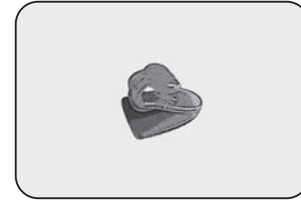

Adapter Clip

The lengths offered by Razor Reach are as follows:

Handle + Head: 6 inch extension

Handle + 1 Arm + Head: 12 inch extension

Handle + 2 Arms + Head: 18 inch extension*

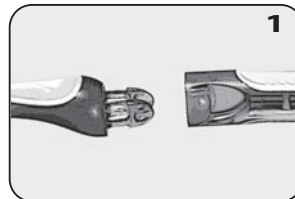

1 Tabs connect Parts

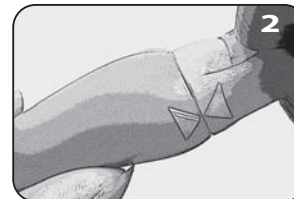

2 Align Triangles

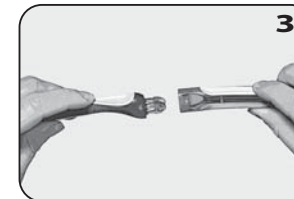

3 Push Together

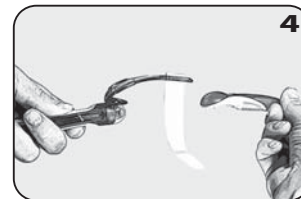

4 Align Razor

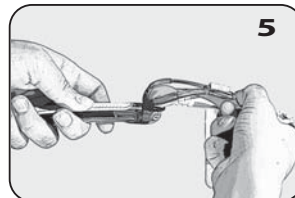

5 Place in Head

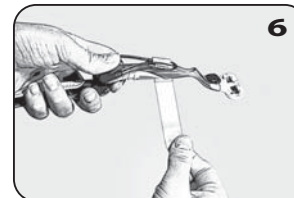

6 Hold Razor Firmly from the Back

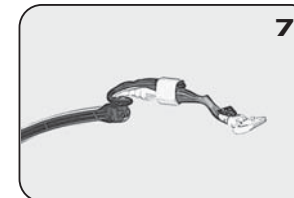

7 Wrap Velcro Tightly

Ready to Use!

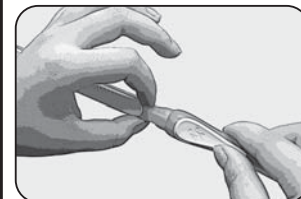
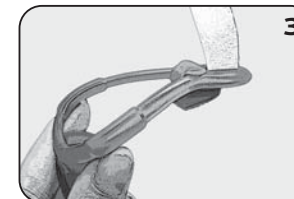

DISASSEMBLY

Squeeze Tabs to release

For Straight Handle Razors attach the Adapter Clip as shown.